

M7159 SERIES

DC/DC POWER SUPPLY

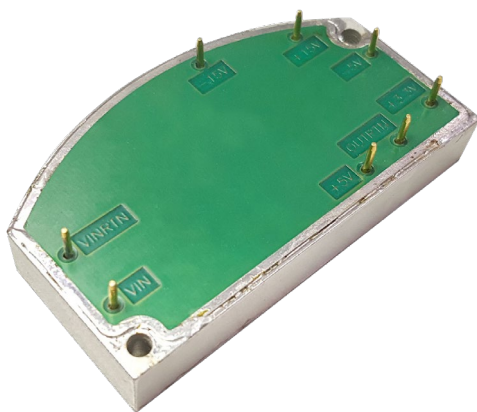

PRODUCT HIGHLIGHTS

- MINIATURE
- HIGH DENSITY
- FIVE OUTPUTS
- DC/DC CONVERTER
- UP TO 30W



Cham, Switzerland
www.enercon-europe.com
enercon@enercon-europe.com
+41-41-740-4554

Global Headquarters

Netanya, Israel
www.enercon.co.il
sales@enercon.co.il
+972-73-246 9200



Gurgaon, India
www.mpsindia.in
sales@mpsindia.in
+91-124-651 0010

APPLICATIONS

Military, Ruggedized, Telecom, Industrial

SPECIAL FEATURES

- Extremely Miniature size
- High efficiency
- Wide input range
- Input / Output isolation
- Fixed switching frequency (400 KHz)
- EMI/RFI filters included
- Indefinite short circuit protection with auto-recovery
- Over-voltage protection -
Passive tranzorbs on outputs
- Over temperature shutdown with auto-recovery

ENVIRONMENTAL

Meets or exceeds MIL-STD-810D

Temperature:

Operating -40°C to $+85^{\circ}\text{C}$ (baseplate)

Storage -55°C to $+125^{\circ}\text{C}$

RELIABILITY

150,000 hours, calculated per MIL-STD-217F at $+85^{\circ}\text{C}$ baseplate, ground fixed.

ELECTRICAL SPECIFICATIONS

DC INPUT

DC Input range: 28 ± 4 VDC

EMI, RFI Filters included

Efficiency: 75% (Typical)

Isolation:

50V between Input and Output

50V between Input and Case

DC OUTPUT (floating)

Line/Load regulation:

Less than 1% (no load to full load, -40°C to $+85^{\circ}\text{C}$)

Ripple and Noise: 50mVp-p, typical (max. 1%)

Current limiting (Hiccup):

Continuous protection for unlimited time

Over voltage protection:

Electronic shutdown with automatic recovery and a passive tranzorb on output.

Over temperature protection:

Shutdown at baseplate temperature of $+105^{\circ}\text{C}$ ($\pm 5^{\circ}\text{C}$)

Automatic recovery at baseplate temperature

lower than $+95^{\circ}\text{C}$ ($\pm 5^{\circ}\text{C}$)

Isolation:

50V between Output and Input

50V between Output and Case

PIN ASSIGNMENT

PIN No.	PIN Function
1	VIN
2	VIN RTN
3	OUT 1
4	OUT RTN
5	OUT 2
6	OUT 3
7	OUT 4
8	OUT 5

OUTLINE DRAWING

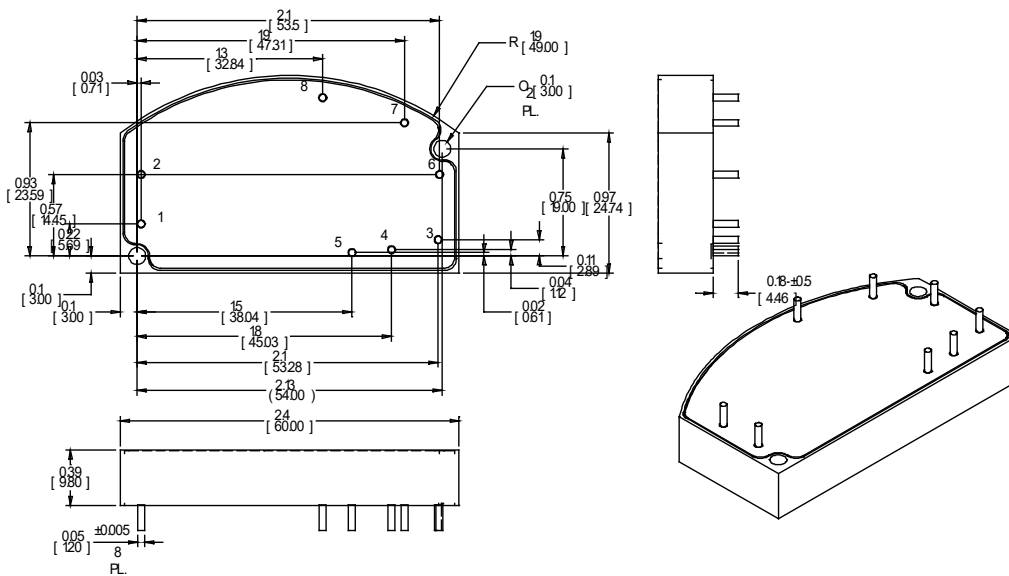

Notes

1. Dimensions are in Inches [mm]
2. Tolerance is:
.XX ±.02 IN
.XXX ±.01 IN
3. Weight: Approx. 35gr (1.2oz)

* Specifications are subject to change without prior notice by the manufacturer